

FILTROS HB SIDE

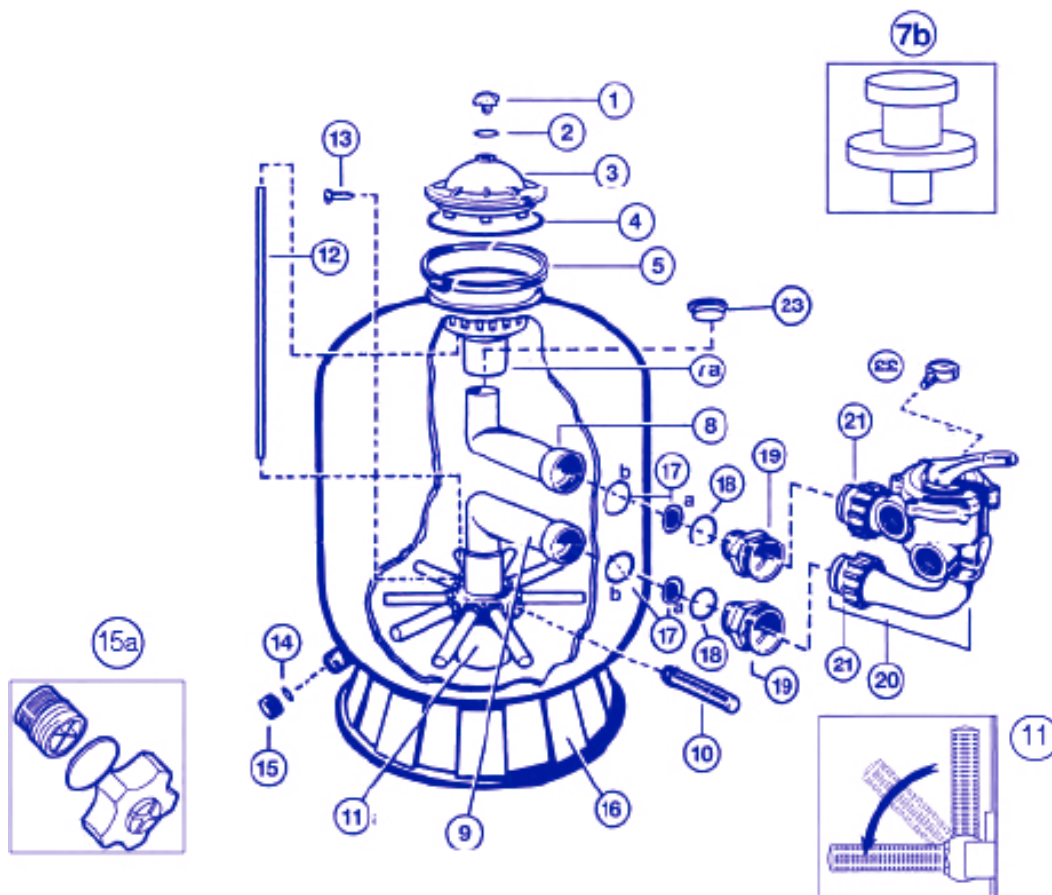

S166SXE  
S210SXE  
S244SXE  
S031SXE  
S0360SXE

PÁG.  
29

PIEZA N°	DESCRIPCIÓN	REF.	UD/CAJA	PRECIO €
1	PURGADOR	SX0200G	1	
2	JUTA TÓRICA DE PURGADOR	SX0200Z5	1	
3	TAPA	SX0244K	1	
4	JUTA TÓRICA DE TAPA	GMX0600F	1	
5	ABRAZADERA			
	S 0166 S / S 0210 S / S 0244 S	GMX0600NM	1	
	S 0310 SE/S 0360 SE	SX0310N	1	
7a/7b	DIFUSOR			
	S166S / S210S / S210SXE / S244SXE / S310SE / S310SXE / S360SE / S360SXE	SX0244G	1	
	S244S / S246S	SX0200L	1	

PIEZA N°	DESCRIPCIÓN	REF.	UD/CAJA	PRECIO €
	<b>CODO SUPERIOR</b>			
	S0166S	SX0166CD	1	
	S0210S	SX0210CD	1	
	S210SXE	SX210CD1FW	1	
8	S0244S / S0246S	SX0244CD2E	1	
	S244SXE	SX244CD1FW	1	
	S0310SE	SX0310CD2	1	
	S0310SXE	SX310CD2FW	1	
	S0360SE	SX0360CD*	1	
	S0360SXE	SX360CDFW	1	
	<b>CODO INFERIOR</b>			
	S0166S	SX0166CD	1	
	S0210S	SX0210CD	1	
	S210SXE	SX210CD2FW	1	
9	S244SXE	SX244CD2FW	1	
	S0310SE	SX0310CD2	1	
	S0310SXE	SX310CD2FW	1	
	S0360SE	SX0360CD*	1	
	S0360SXE	SX360CDFW	1	
	<b>CREPINA (X10)</b>			
10	S0166S / S0210S / S210SXE	SX200QNPAAK10	10	
	S0244S / S0246S / S244SXE	SX240DNPAK10	10	
	S0310SE / S310SXE / S0360SE / S360SXE	SX310HNPAK10	10	
	<b>ASIENTO DE CREPINAS CON TUBO</b>			
	S0166S	SX0164DA3E	1	
11	S0210S	SX0242MA	1	
	S0244S	SX0242MA1	1	
	S0310SE	SX0242MA2	1	
	S0360SE	SX0242MA3	1	
	<b>TUBO DE EVACUACIÓN DE AIRE</b>			
12	S0244S / S0246S / S244SXE	CX1100Z4	1	
	S0310SE / S310SXE	SX0200Z1	1	
13	<b>TORNILLO DEL TUBO DE EVACUACIÓN DE AIRE</b>	SX0200Z2	1	
14	<b>JUNTA DEL TAPÓN DE VACIADO</b>	SX0180G	1	
15	<b>TAPÓN DE VACIADO</b>	SX0180H	1	
15a	<b>TAPÓN DE VACIADO</b>	SX180LA	1	
	<b>BASE DE SOPORTE</b>			
16	S0166S	SX0164B	1	
	S0210S / S 0244S	SX0200J	1	
	S0310SE / S 0360SE	SX0310J	1	
	<b>ADAPTADOR DE ESTANQUIDAD</b>			
17a	S0166S / S0210S / S0246S / S0310SE	SX0244DE	2	
	S210SXE / S244SXE / S0310SXE / S0360SXE	SX360E	2	
	S0360SE	SX0360DE	2	
	<b>JUNTA DEL ADAPTADOR DE ESTANQUIDAD</b>			
17b	S0166S / S0210S / S0246S / S0310SE	SX0244DE1	2	
	S210SXE / S244SXE / S0360SE / S0310SXE / S0360SXE	SX0360Z1	2	
	<b>JUNTA TÓRICA DE TRAVESERA DE PARED</b>			
18	S0166S / S0210S / S0246S / S0310SE	SX0220Z2	2	
	S210SXE / S244SXE / S0360SE / S0310SXE / S0360SXE	SX0360Z1	2	
	<b>TRAVESERA DE PARED</b>			
19	S0166S / S0210S / S0244S / S0310SE	SX0200DL1	2	
	S210SXE / S244SXE / S0310SXE	SX244PX	2	
	S0360SE / S0360SXE	SX311F	2	
	<b>VÁLVULA</b>			
20	S0166S	SP0710X32E	1	
	S0210S / S210SXE / S0246S / S0244SXE	SP0719SE	1	
	S0310SE / S0310SXE / S0360SE / S0360SXE	SP0715X62E	1	
21	<b>JUNTA TÓRICA DE VÁLVULA (X2)</b>	SX200Z4PAK2	2	
22	<b>MANÓMETRO</b>	ECX271261	1	
	<b>TAMIZ DE DRENAJE</b>	SX0200H	1	